

FOR SALE

£260,000

14 Suffolk Road,
Southsea, PO4 8EJ.

ESTATE  AGENTS

**LAWSON
ROSE**

GROUND FLOOR

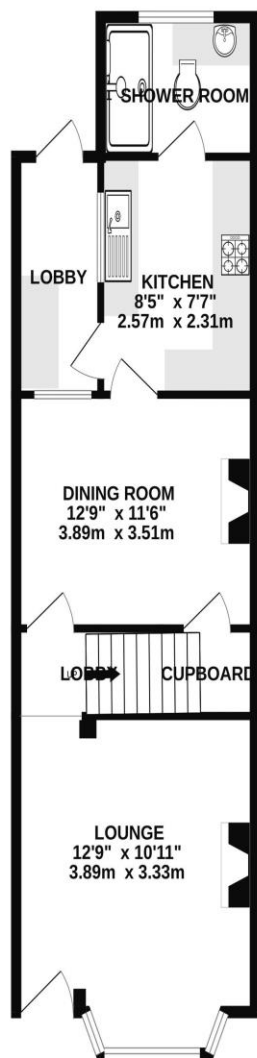

1ST FLOOR

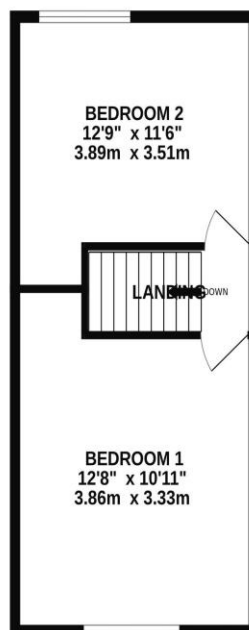

Score	Energy rating	Current	Potential
92+	A		
81-91	B		85 B
69-80	C		
55-68	D	65 D	
39-54	E		
21-38	F		
1-20	G		

Whilst every attempt has been made to ensure the accuracy of the floorplan contained here, measurements of doors, windows, rooms and any other items are approximate and no responsibility is taken for any error, omission or mis-statement. This plan is for illustrative purposes only and should be used as such by any prospective purchaser. The services, systems and appliances shown have not been tested and no guarantee as to their operability or efficiency can be given.
Made with Metropix ©2023

£260,000

14 Suffolk Road, Southsea

This well presented two bedroom, bay & forecourt property has been updated and modernised in its recent history and is close to local amenities on Milton Road and Bransbury Park. Situated on Suffolk Road, the property provides a bright and airy living room with large bay window, a formal dining room plus a stylish fitted kitchen and shower room with a handy lean to/ utility area, with the first floor then providing two great sized double bedrooms. Additionally the house is double glazed and gas centrally heated, plus there is a landscaped rear garden with a raised decking to its rear. An ideal first time or investment purchase in our opinion and therefore we highly recommend an internal viewing. For further information or to arrange a viewing, please contact the sales team today.

Services

Electricity, gas, mains water and mains drainage are available. Please note that none of the services or appliances have been tested by Lawson Rose.

Council Tax - Band B



02392 367 779 - contactus@lawsonrose.com
131 Winter Road, Southsea, P04 8DS



